



NORTHSTAR™



G403 SERIES
MULTI-LEVEL
GLASSWARE
WASHER/DRYER

NORTHSTAR™ G403 SERIES MULTI-LEVEL LABORATORY GLASSWARE WASHER/DRYER

The Northstar G403 glassware washer/dryer is the result of a progressive approach to washer design. An approach that combines cleaning performance, ease of use and long-term durability to meet the demands of today's busy laboratories.

■ Multi-level washing for greater productivity

The Northstar G403 is designed to hold laboratory glassware on up to four levels. Each level has a positive fit to the spray system to achieve uniform spray pressure. If a level is not being used the connection point remains sealed. Racks are fully supported so that they can be pulled forward into a cantilevered position for loading. A wide choice of spindle racks or open baskets are available from our accessory list.

■ High pressure spray and total coverage

Cleaning and rinsing solutions are distributed through a combination of rotating spray arms and individual spindle jets to insure complete coverage. Our control system ensures that spray solution is heated to the correct temperature for optimum cleaning and rinsing.



■ Micro-processor touch pad control

Microprocessor controls allow the user to easily select from twelve automatic cleaning cycles. Each cycle can be preset for time, temperature, multiple washes, multiple rinses and water saving for maximum efficiency. Cycle stage indicator and current temperatures are clearly displayed.



■ Single or Pass-thru Doors

The G403 washer is designed with automatic vertical lift doors, in either single or pass-thru configuration. Doors are opened with the touch of a button for loading and open again automatically at the end of the process cycle. All doors have a large viewing window and are insulated to reduce noise and heat transfer into the room.

Automated load and unload modules are available as an option to increase productivity. Loads are recognized and cycles are selected automatically. Up to two glassware loads can be set on the system and will advance when the washer has completed its cycle. Note: see factory for accessory rack compatibility when auto-load and unload modules are used.

NORTHSTAR™ G403 SERIES LOADING EQUIPMENT AND ACCESSORIES

Glassware Spindle Headers

No.	Description	Maximum Size Ware
SH-4-403	4 spindle header	up to 12" dia.
SH-25-403	25 spindle header	up to 5" dia.
SH-49-403	49 Spindle header	up to 3.375" dia.
SH-81-403	81 spindle header	up to 2.75" dia.
SH-110-403	110 spindle header	up to 2.188" dia.
BRH-403	Bottom Rotary	General Cleaning

Additional accessories are available.

- See factory for details



TRANSFER CART
(SHOWN WITH HEADERS)

▪ Solid construction for durability

All Northstar washers are built with durability in mind. Cabinets and doors are fully welded from stainless steel and polished to a satin finish. The complete solution circulation system, including pumps, flanges, pipe connections, and loading equipment is constructed of type 304 stainless steel for compatibility with all types of detergents. Type 316L stainless steel is available as an option. No plastic or rubber piping connections are used.

▪ Pump information

Our Northstar model G403 multi level glassware washer/dryer uses a 3hp pump for excellent cleaning results.



NORTHSTAR™ G403 SERIES MULTI-LEVEL LABORATORY GLASSWARE WASHER/DRYER

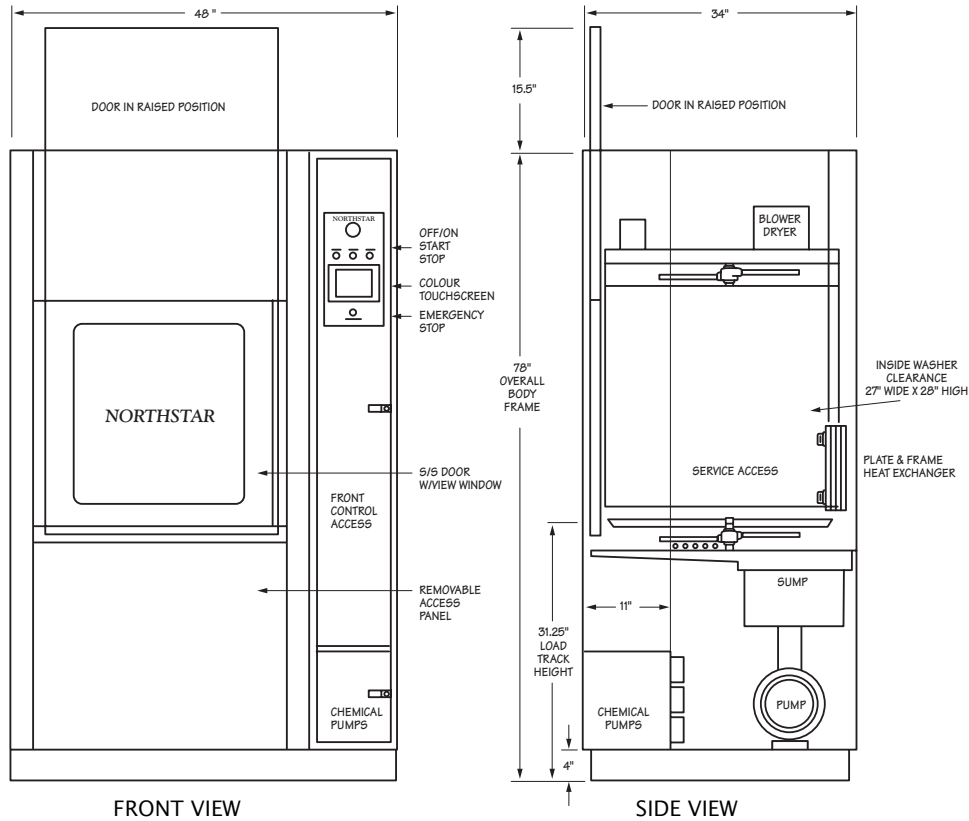

STANDARD DIMENSIONS

NOMINAL SIZES

MODEL	DOOR CONFIGURATION	INTERIOR DIMENSIONS	OVERALL DIMENSIONS
		W x H x D	W x H x D
G403	VERTICAL	27" x 28" x 27" 68.6cm x 71.1cm x 68.6cm	48" x 78" x 34" 121.9cm x 198.1cm x 86.4cm

Note: Vertical door in the raised position will require an overall height of 93.5" (237.5cm) A.F.F.
 G403 available as a two-door pass-thru. Contact factory for details.
 Dimensions are maximum openings. Load sizes must be smaller to allow for clearance.

ADDITIONAL PRODUCTS FROM NORTHWESTERN SYSTEMS

Cage & Rack Washers ▪ Tunnel Washers ▪ Bottle Fillers ▪ Necropsy Tables
 Custom Fixtures ▪ Bedding Handling Equipment ▪ Custom Stainless Steel Work Stations



NORTHWESTERN SYSTEMS CORP
 #260 - 4611 VIKING WAY, RICHMOND
 BRITISH COLUMBIA, CANADA, V6V 2K9
 TEL (604) 279-0279 • FAX (604) 279-0293
 TOLL FREE: 1-888-553-0855
 E-MAIL: sales@nsc-northstar.com
 WEBSITE: www.nsc-northstar.com